

Display Stuff Better.

## CHARGING TABLE WITH 6 RETRACTING CABLES, 1 WIRELESS PAD, AND CUSTOM PRINTED GRAPHICS, PORTABLE

Assembly Instructions

SKU: CHRTBTRCP (Charging Table)

SKU: CHRTBTRG (Replacement Graphic)

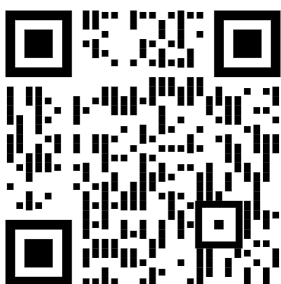

Scan the QR  
code to visit the  
product page.



## Components

PART	QUANTITY
A: Tabletop .....	1
B: Base Plate.....	1
C: Power Cord .....	1
D: Pole .....	8
E: Screw Knob.....	4
F: Tension Cloth .....	1
G: Travel Bag .....	1

## Safety & Warnings

-  Displays2go is not responsible for any personal injury or product damage due to mishandling, incorrect mounting, incorrect assembly or incorrect use of this product. Please follow these instructions to avoid risk of electric shock and/or short circuit.
- Ensure the product is installed in a way that prevents a person tripping over power cable or the unit falling from location.
  - Do not install in an area with high temperature, high humidity, or areas where the charging table may come in contact with water. Do not install near air conditioners or areas with excessive smoke, dust, or vibration.
  - Do not use the product or any parts if they are damaged.
  - All cables and adaptors should be connected or disconnected slowly and carefully.
  - The product is self-service, i.e. users do not require assistance to recharge their device. Always disconnect the power cord from the main power outlet first.
  - Do not clean the product until the unit is powered off and unplugged from the main power outlet. Once unplugged, clean using a dry or slightly damp cloth. Avoid using cleaning products and do not allow liquid to enter the device.
  - Do not install in a location where a person could potentially trip on the power cord or the product.

### **Power Specifications**

Input: 110-240V, 50-60Hz

Output: 6x 5V/2.1A

Qi Output: 5V/1A

## Assembly

1. Insert the cloth edge into the channel of the base.
2. Connect all poles to create 4 full-length poles.

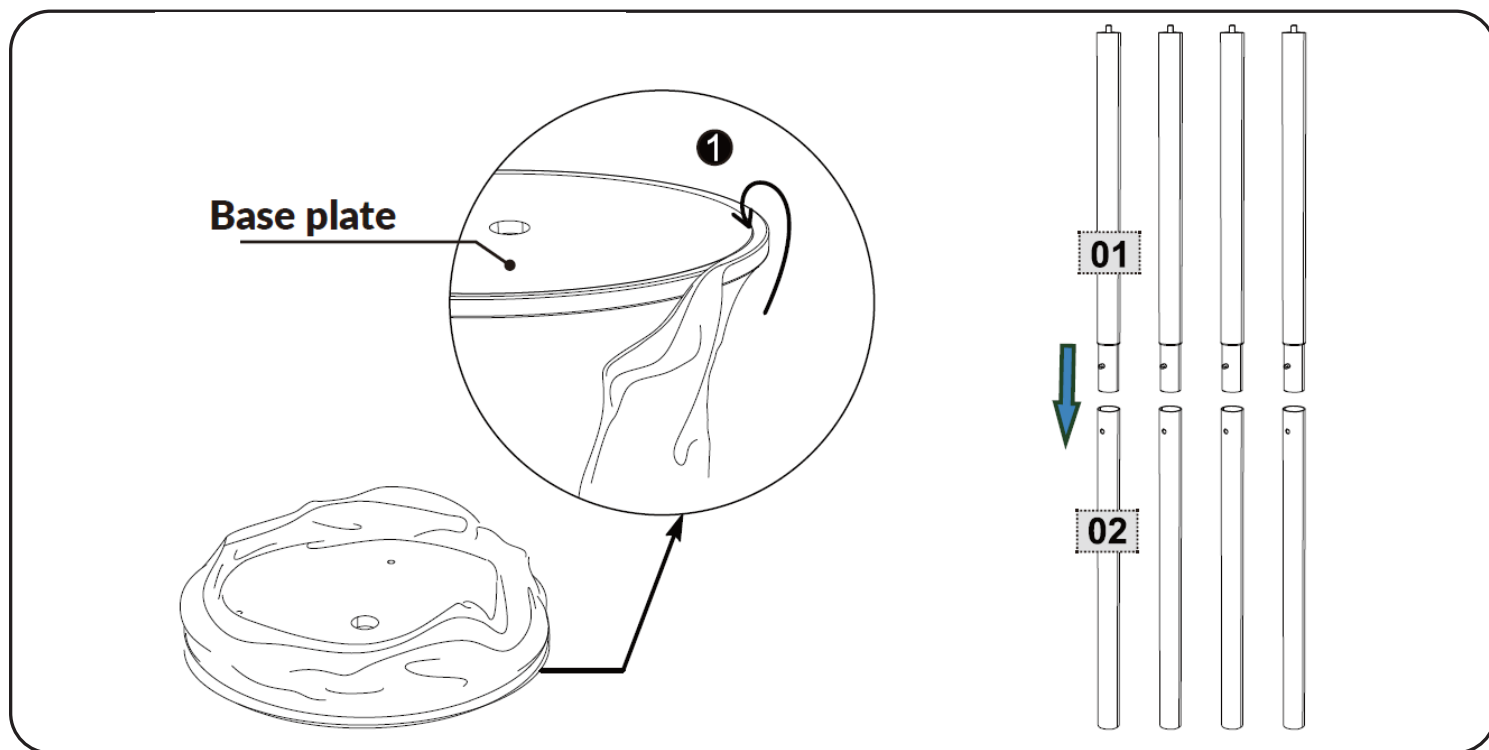

3. Insert poles into the tabletop and turn to tighten.
4. Secure the base plate onto poles with 4 screw knobs.

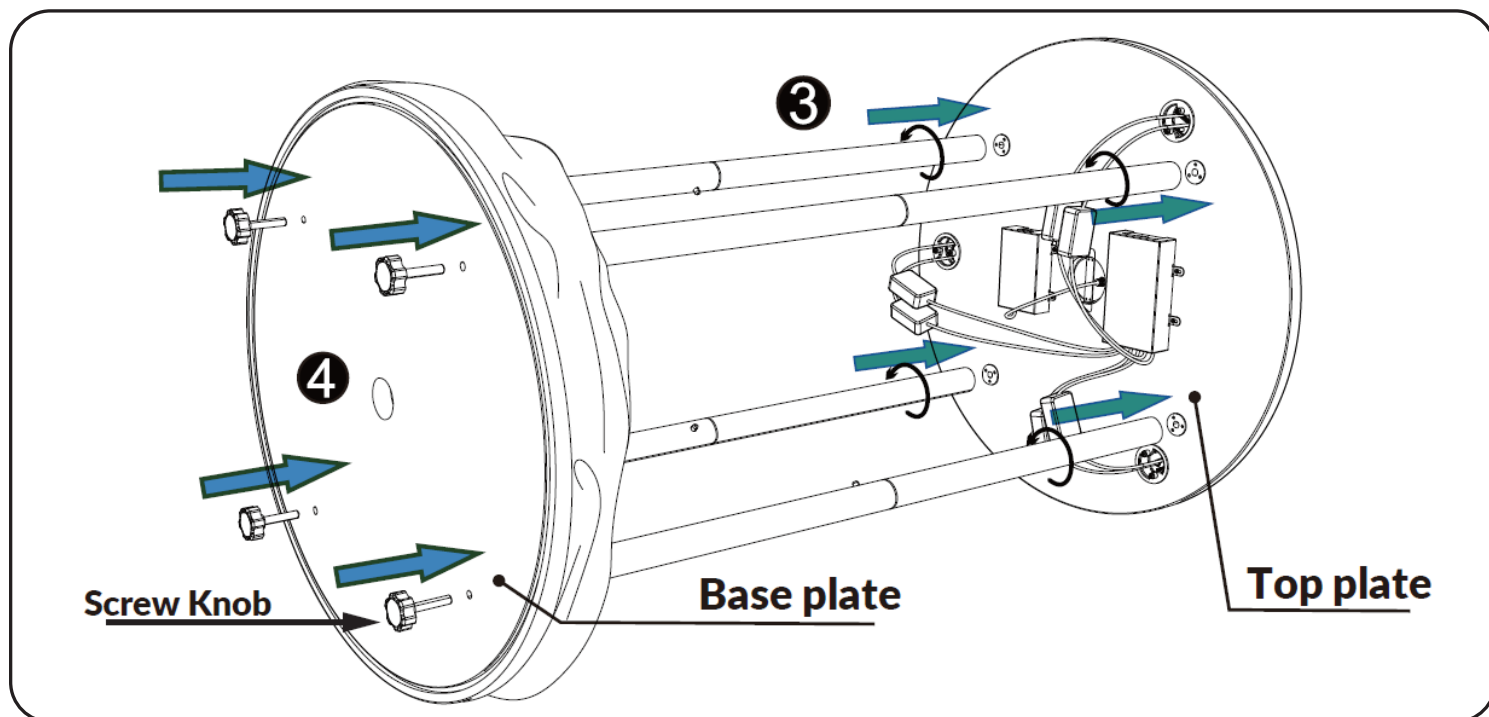

5. Connect power extension cable to the power box.
6. Pull the power extension cable out through the hole of the base.
7. Place a weight (not included, approximately 13lbs recommended) onto base to enhance the stability of the charging table.

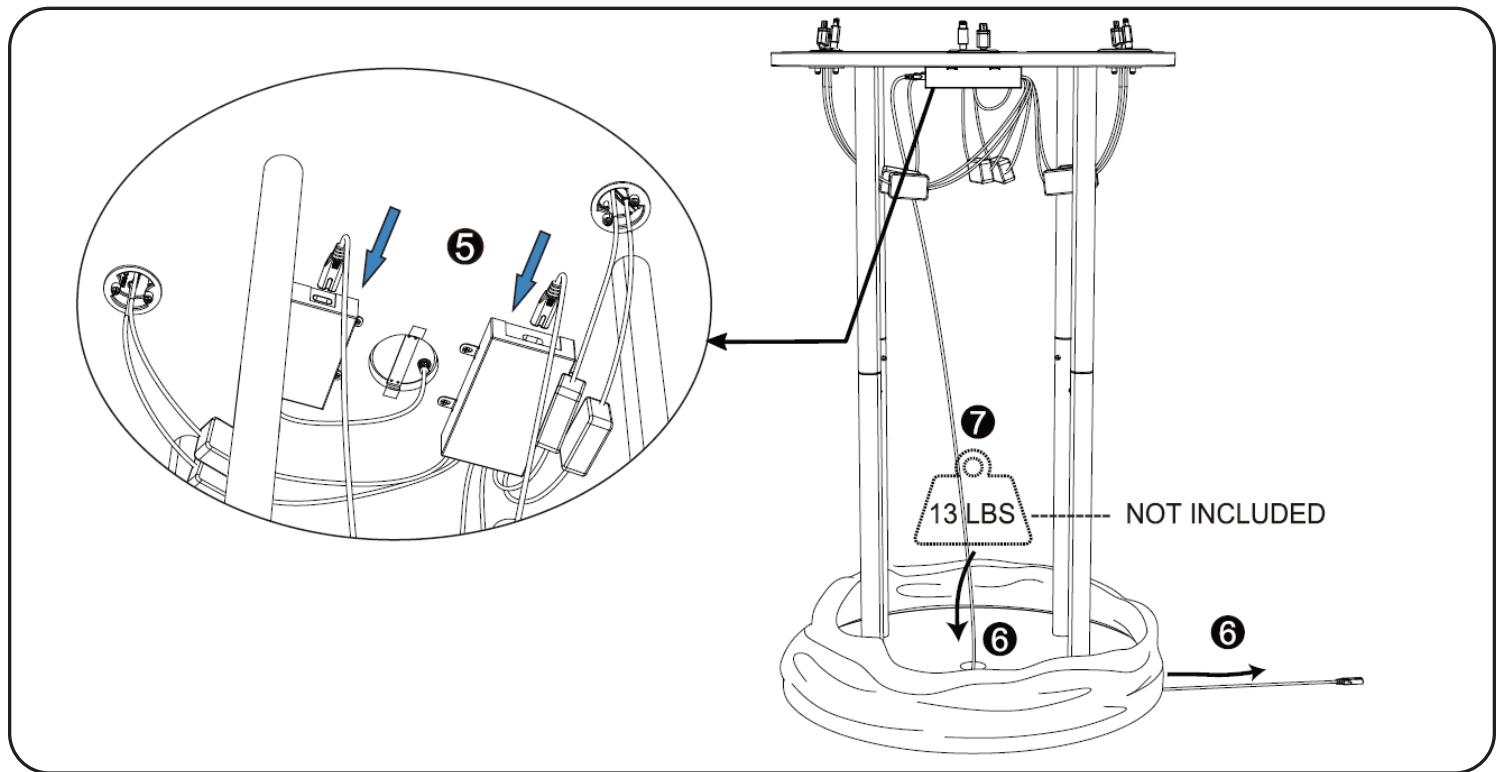

8. Insert the other cloth edge into the channel of the tabletop.
9. Connect power cord to power.

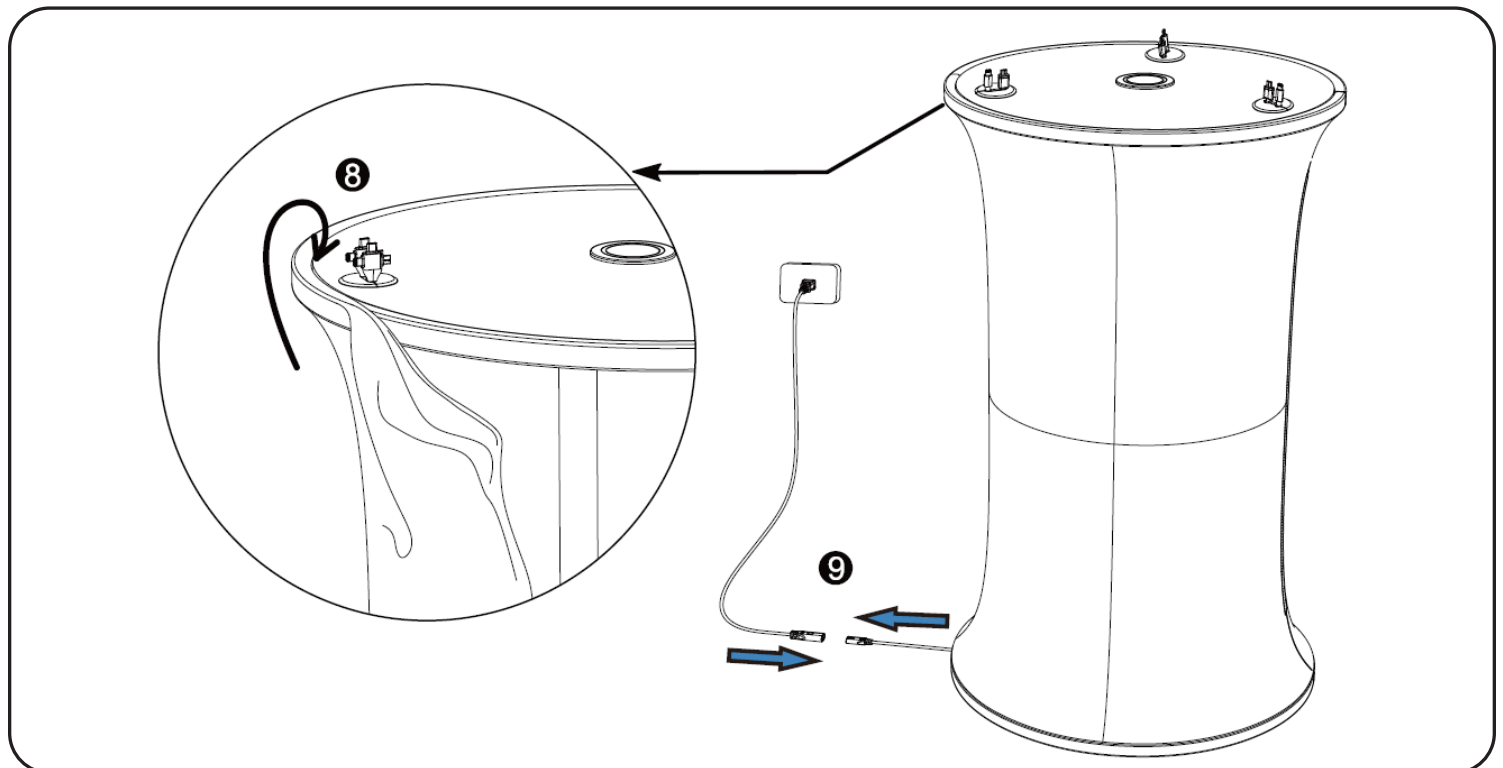

## Replacing Charging Cables

1. Before replacing a cable, disconnect unit from power.
2. Unscrew the 2 screws to detach cable clip.
3. Unscrew the 2 screws on the Power Box cable.
4. Remove cover and replace cable in cable clip.
5. Replace cover and screws on both Power Box and cable clip.
6. Reconnect unit to power.

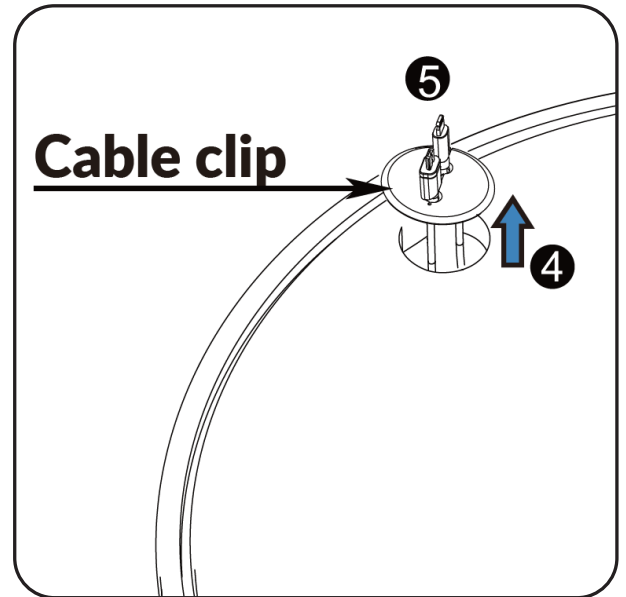
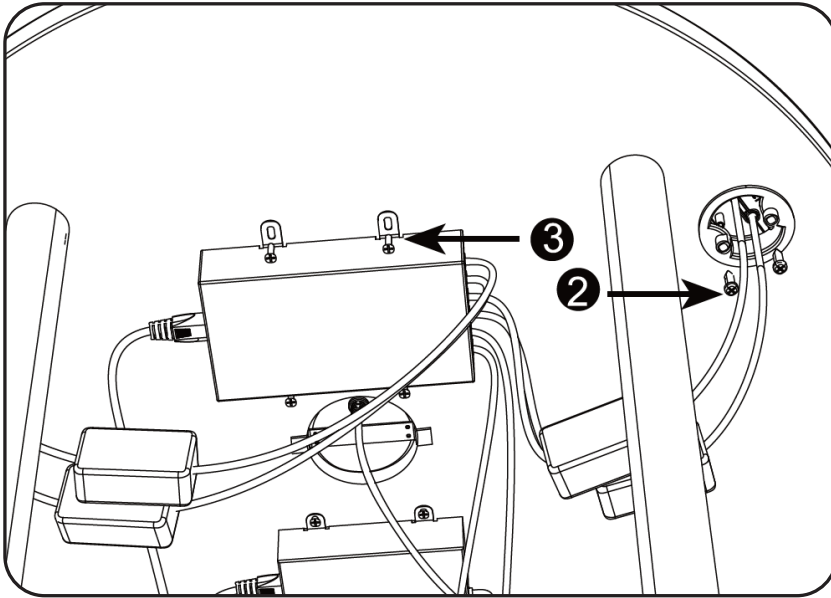

Assembly is complete.

If you have any questions regarding our products, please visit us at [www.displays2go.com](http://www.displays2go.com) or contact Displays2go customer service at 844-221-3388.